



## Peels are easy to use but please read this first!

- **Please check** the copy of your order on the reverse of this sheet.
- **Don't judge the colours beforehand.** The full beauty of the colours will only be seen when Peels are applied to your windows.
- **The unique overall texture** is essential to give Peels the modelled effect of stained glass and does not lead to any apparent light loss.
- **Some shrinkage**, due to the nature of the material on which Peels are produced, will occur when removed from its backing sheet. If possible an extra 1/2 inch (12mm) should be allowed for trimming to final size on your windows.
- **Electrostatic properties** are always retained and your designs will not fall off.
- **Cleaning** can be done with a cloth and a little soapy water. Avoid lifting the edges.

### Detailed instructions

**Fig.1** Begin by cleaning the glass thoroughly to remove all traces of dirt and grease. Make careful measurements allowing for shrinkage. If you are using lead, this should be applied now, and well 'boned down' at this stage. (See instructions on lead).

**Fig.2** Cut the design approximately to size on the backing sheet. This allows for accurate trimming later, when it has been positioned finally on the glass.

**Fig.3** Use a sponge to spread soapy water (washing-up strength) over the glass **THE WETTER THE BETTER!** This enables you to slide the design sheet into position easily. You will find your Peels glass transfer easier to handle if it is applied out of direct sunlight and on to cool glass.

**Fig.4** Peel away from the backing sheet and position the design on the glass. **THE SURFACE THAT WAS ON THE BACKING SHEET GOES ON THE GLASS.** If you are not happy with the position, just peel off and start again. However if left off the glass for any length of time the material could shrink.

**Fig.5** Wet the surface of the design also with the sponge and then use the smoothing tool to smooth down the design into position. Work from the centre outwards to squeeze out the soapy water and any air bubbles.

**Fig.6** Finally using a very sharp knife and ruler, trim away the excess material. You may find it easier to mark with a biro, move to a clear piece of glass, trim and reapply in original position. Make sure that the glass transfer does **NOT** overlap paint, putty or seals. Peels adhere to glass. It will lift if the edges are not lying flat on the glass. **DON'T LEAVE IT- DEAL WITH IT!**

**Fig.7** If you need to add extension pieces to your design, this is the time to do it. It is best to butt the pieces together along a 'leading' line. When adding extra pieces, the sheets should be overlapped, and then using a straight edge you can cut through both layers along the edge of the 'leading' making a neat butt join. If you have multi-paned windows/doors or unusual shapes, it is best to cut a template out of thin card to help you mark, cut and position your design.

**Fig.8** Borders are best fitted last. A length of white plastic is supplied with all full border sheets to serve as a cutting edge and border width guide. By placing the strip along the edge of the window, you can cut and peel away the exact width of the design, which will then be replaced with the border strip.

**Fig.9** The length of white plastic can also be used when cutting the border from its backing sheet and this method will ensure accuracy. Again, borders are applied with soapy water and smoothed out. **DO NOT STRETCH.** Joining at corners is best achieved by either 'hiding' one edge under the lead line of the other strip, or a complete overlap at the corner is also effective but **NOT WITH THE FROSTED VERSION.**

**Fig.10** Window glazing bars are not a problem, but the width of bar should be removed from some design sheets if this should cause a visual distortion of your design.



1



2



3

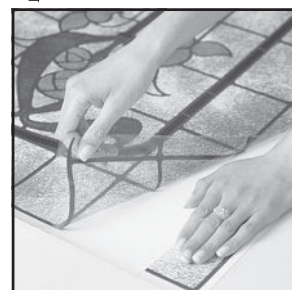

4



5



6

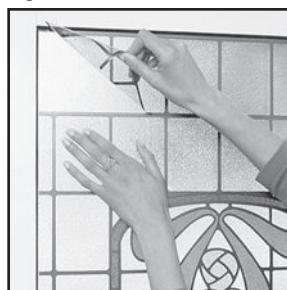

7

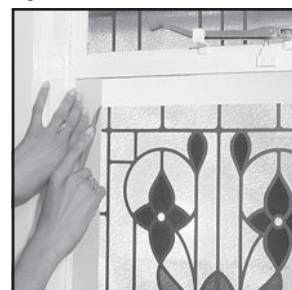

8



9

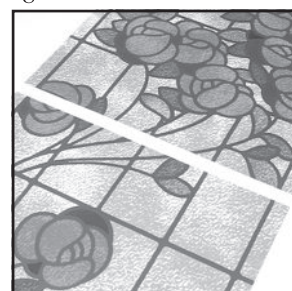

10

*We are happy for you to telephone us with any specific questions you may have and we will endeavour to offer helpful suggestions.*

**Peels of London Unit 20 Wickham Business Centre, Harwood Road. BN17 7AU 020 8948 0689 info@e-peels.co.uk**

*Peels are guaranteed to resist discolouration and fading for a minimum of 5 years, with normal use.*

*If you are not delighted with any Peels design, you may return it in the mailing tube supplied within fourteen days of receipt for a full refund.*

*Returns must be undamaged and not have been removed or peeled back in any way from their original backing sheet.*